

Breakfast
7:30 – 9:00
Plaza Ballroom Foyer



SouthEast SAS® Users Group

Monday Morning Schedule At A Glance

Registration Desk
7:00 – 5:00
Plaza Ballroom Foyer

<p>Opening Session <i>Barbara Okerson & Marje Fecht</i></p> <p>Keynote Take a Trip Down Memory Lane <i>Rick Langston</i></p> <p><i>Plaza Ballroom B & C</i></p> <p><i>(Pick up your breakfast in the Plaza Ballroom Foyer. Tables and coffee available in the ballroom)</i></p> <p>Schedule At a Glance Sponsored By</p>	8 ⁰⁰	8 ³⁰	9 ⁰⁰	9 ³⁰	10 ⁰⁰	10 ³⁰	11 ⁰⁰	11 ³⁰	12 ⁰⁰			
	Becoming a Better Programmer with SAS® Enterprise Guide® 4.3 <i>Kate Schwarz, 23</i>	sas		Loading Metadata to the IRS Research Compliance Data Warehouse (CDW).... <i>Robin Rappaport, 23</i>	PIPE Dreams: Yet Another Tool for Dynamic Programming <i>Scott Burroughs, 24</i>	Using Recursion for More Convenient Macros <i>Nate Derby, 24</i>	Using SAS® Variable Lists Effectively <i>Howard Schreier, 24</i>	Beyond the Basics <i>Plaza II</i>				
	Counting the Ways to Count in SAS® <i>Imelda Go, 31</i>	SAS® Formats: Effective and Efficient <i>Harry Droogendyk, 31</i>	Locally Visible, Remote Data and Format! <i>Hsiwei Yu, 31</i>	Arrays - Data Step Efficiency <i>Harry Droogendyk, 32</i>	Smoothing Scaled Score Distributions from <i>Jonathan Steinberg, 32</i>	Identifying, Tracking, and Analyzing Patterns... <i>Vijayalakshmi Sampath, 33</i>	Our Adverse Event Review Reports.... <i>David Maddox, 33</i>	Macros for Two-Sample Hypothesis Tests <i>Jinson Erinjeri, 33</i>	Windows PowerShell Commands and Scripts <i>Adeline Wilcox, 34</i>	Be Bold with Proc Compare and %RTFTable <i>Patricia Guldin, 34</i>	SAS® Programming Guidelines <i>Lois Levin, 34</i>	Coders Corner <i>Juniper</i>
	Tips for Merging SAS/GRAPH® Output into Microsoft PowerPoint <i>Ferrell Drewry, 40</i>	A General-Purpose SAS® Report Portal for the Web <i>Craig Ray, 40</i>	Fighting Fraud in a Pre-Payment Environment <i>Greg Henderson, 41</i>		sas		Automatization of Patient Characteristics Report <i>Mirjana Stojanovic, 41</i>	Macro Design and Usage in a Multi-Tier Architecture for ETL... <i>Manuel Figallo-Monge, 42</i>	Government and Healthcare Applications <i>Plaza I</i>			
	Output Delivery System (ODS) - Simply the Basics <i>Kirk Paul Lafler, 47</i>			SAS® Enterprise Guide® 4.3: Finally a Programmer's Tool <i>Marje Fecht, 47</i>			Hands On Workshops <i>Beech</i>					
	Introduction to ODS Graphics for the Non-Statistician <i>Mike Kalt, 64</i>		sas		A PICTURE is Worth ALOT of PUTS <i>Carol Martell, 64</i>		Using SAS® GTL to Visualize Your Data when there is Too Much of it to Visualize <i>Perry Watts, 64</i>		Reporting & Information Visualization <i>Plaza III</i>			
Analysis of a Complex Survey Data <i>Varma Nadimpalli, 71</i>		Time Series Analysis: Separating Overlapping Events <i>M. Scott Elliott, 71</i>		Find Potential Fraud Leads Using Data Mining Techniques <i>Qiling Shi, 71</i>		Proc MIXED - Right Options to get Right Output <i>Sheetal Nisal, 72</i>		PROC SURVEY...Says!: Selecting and Analyzing Stratified Samples <i>Darryl Putnam, 72</i>		Statistics and Data Analysis <i>Aspen</i>		
What's New in SAS® Enterprise Guide® <i>Erin Lynch, 16</i>		500 Control Charts or 5? The Power of Multivariate Process Monitoring <i>Bob Rodriguez, 16</i>		A Different Point of View with ODS PDF 9.3 <i>Bari Lawhorn, 16</i>		Super Demo Theater <i>SAS® Demo Room - Terrace</i>						
Do you have Code / Logic problems? <i>Code Doctors can identify the symptoms, diagnose the problem, and prescribe the treatments</i>				Code Doctors on Duty: <i>Sunil Gupta Denise Kruse</i>				Code Doctors <i>SAS® Demo Room - Terrace</i>				

Breaks 10:15 – 11:00 3:00 – 3:45 <i>Plaza Ballroom Foyer</i>	Lunch 11:45 – 1:15 <i>Plaza B & C</i>	SAS® Demo Room 9:00 – 12:00 1:00 – 5:00 <i>Terrace</i>	Speaker Rehearsal 9:00 – 12:00 1:00 – 5:00 <i>Birch</i>	Posters – Meet the Authors 2:00 – 3:00 <i>Plaza Ballroom Foyer</i>	SAS® User Appreciation Mixer 5:00 – 6:30 <i>Terrace</i>
--	--	--	---	---	--

Monday Afternoon Schedule At A Glance

1 ⁰⁰	1 ³⁰	2 ⁰⁰	2 ³⁰	3 ⁰⁰	3 ³⁰	4 ⁰⁰	4 ³⁰	5 ⁰⁰			
SAS® Programming Tips and Techniques <i>Kirk Paul Lafler, 25</i>		From Obscurity to Utility: ADDR, PEEK, and POKE as DATA Step Programming Tools <i>Paul Dorfman, 25</i>		An Introduction to SAS® Hash Programming Techniques <i>Kirk Paul Lafler, 26</i>		The SAS® Magical Dictionary Tour <i>Linda Libeg, 26</i>		Paperless Report Generation and Distribution <i>George Sharrard, 27</i>		Beyond the Basics <i>Plaza II</i>	
Let SAS® Do the Downloading: Using Macros to Generate FTP Scripts <i>Arthur Furnia, 42</i>	Categorizing the Degradation State of Aircraft Generators using Rank Order... <i>Tsung-hsun Tsai, 43</i>	Healthcare Provider Cost Reporting Information System <i>Kim Andrews, 43</i>		Analysis of a Binary Outcome Variable Using the FREQ and LOGISTIC Procedures <i>Arthur Li, 44</i>		ODS PDF and RTF application development <i>Benno Kurch, 44</i>		Creating Correlated Variable Tables Dynamically <i>John Barrow, 45</i>		Government and Healthcare Applications <i>Plaza I</i>	
Easier than You Think: Creating Maps with SAS® Enterprise Guide® <i>Stephanie Thompson, 48</i>			Creating Stylish Multi-Sheet Microsoft Excel Workbooks the Easy Way with SAS® <i>Vince DelGobbo, 48</i>			sas			Hands On Workshops <i>Beech</i>		
JMP® Analytics Applied in Diagnostic Radiology and Neurosurgery Trauma Research <i>Melvin Alexander, 50</i>		Making Your SAS® Data JMP® Through Hoops <i>Mira Shapiro, 51</i>		JMP®ing in: A SAS® Programmer's look at JMP. <i>Barbara Okerson, 51</i>		Create compelling visualizations with geographic data and JMP® 9 <i>Jeff Perkinson, 51</i>		Evaluating Consumer Price Behavior Using JMP® <i>Josh Klick, 52</i>		JMP <i>Plaza III</i>	
On Deck: SAS/STAT® 9.3 <i>Robert Rodriguez, 73</i>		sas		Tailoring Logistic Regression Model Analyses with the ODDSRATIO <i>Taylor Lewis, 73</i>		Data Simulation for Evaluating Statistical Methods in SAS® <i>Rick Wicklin, 73</i>		sas		Statistics and Data Analysis <i>Aspen</i>	
In Lockstep with the DoW-Loop <i>Paul Dorfman, 67</i>		Misquoting Jane Austen in the Name of Quality <i>Deborah Posner, 67</i>		Let's Give'em Something to TOC About: Transforming the Table of Contents of Your PDF File <i>Bari Lawhorn, 68</i>		sas		Wandering Cross Reference Lines in PROC GPLOT <i>Sharon Avrunin-Becker, 68</i>		Step By Step <i>Juniper</i>	
ODS Graphics Designer for Pain Free Graphics <i>Mike Kalt, 16</i>		What's new in PROC FORMAT in 9.3 <i>Rick Langston, 17</i>		SAS® Fraud Framework <i>Greg Henderson, 17</i>		Super Demo Theater <i>SAS® Demo Room - Terrace</i>					
Do you have Code / Logic problems? <i>Code Doctors can identify the symptoms, diagnose the problem, and prescribe the treatments. Walk-Ins Welcomed!</i>				Code Doctors on Duty: <i>Christianna Williams Maribeth Johnson</i>				Code Doctors <i>SAS® Demo Room - Terrace</i>			

<p>Posters</p> <p>Monday 8:00-5:00</p> <p>Tuesday 8:00-12:00</p> <p><i>Plaza Ballroom Foyer</i></p>	Coping with Job Loss <i>Dianne Rhodes, 53</i>	Using SAS® to Ease the Proofing of Messy Text <i>Richard La Valley, 53</i>	Scatter Plots Using PROC SGPLOT for that Thursday Presentation <i>Sharon Hirabayashi, 54</i>	A Macro to Change Windows Filenames <i>Daniel Levitt, 54</i>	CI_MEDIATE: A SAS® Macro for Computing Point and Interval Estimates of Effect Sizes Associated with.... <i>Thanh Pham, 54</i>	MISSING_ITEMS: A SAS® Macro for Missing Data Imputation in Summative Response Scales <i>Patricia Rodriguez de Gil, 55</i>	
	Using SAS® to Streamline Periodic Reporting of Summary Statistics: Proc Format, Proc Freq, Proc Means and Output Delivery... <i>Benwyn Gonzalvo, 56</i>	Using SAS® to Examine Aging Expectation (ERA-38) for Older Adults <i>Abbas Tavakoli, 56</i>	Resolving OpenCDISC Error Messages Using SAS® <i>John Gerlach, 57</i>	Time Series Regression: Using Proc GPLOT and Proc REG Together to Make One Great Graph <i>William Zupko, 58</i>	Using SAS GTL to Visualize Your Data when there is Too Much of it to Visualize <i>Perry Watts, 58</i>	Practical Approaches to Counting in SAS®: How to Get Started When You Don't Know Where to Begin <i>Sharon Avrunin-Becker, 59</i>	Using Dictionary Tables to Profile SAS® Datasets <i>Phillip Julian, 59</i>
	MV_META: A SAS® Macro for Multivariate Meta-Analysis <i>Julie Gloudermans, 59</i>	Proc CDISC: Implementation and Assessments <i>Sheetal Nisal, 60</i>	Permutated-block randomization with varying block sizes using SAS® Proc Plan <i>Lei Li, 60</i>	A Coding Practice for Preparing Adaptive Multistage Testing <i>Yung-chen Hsu, 61</i>	Breastfeeding in Developing Countries: A Case Study of Nepalese Children <i>Parwen Parhat, 61</i>	Business Intelligence and Analytics: Complements within a Decision Support Culture <i>Alan Mann, 62</i>	Does SAS® Distance Measurement Differ from ArcGIS Distance <i>Imam Xieraili, 63</i>

Legend

Modular Programming: MacRoe, 45

Paper Title:

Primary Author:

Abstract Page in Program:

SAS Institute Presenter

Presenter or Coauthor is a Student Scholarship Winner

Breakfast
7:30 – 9:00

Plaza Ballroom Foyer

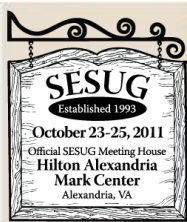

SouthEast SAS® Users Group

Tuesday Morning Schedule At A Glance

Registration Desk
7:30 – 2:00

Plaza Ballroom Foyer

	8 ⁰⁰	8 ³⁰	9 ⁰⁰	9 ³⁰	10 ⁰⁰	10 ³⁰	11 ⁰⁰	11 ³⁰	12 ⁰⁰	
Tuesday General Session <i>Barbara Okerson, Marje Fecht, Sarah Woodruff & Peter Eberhardt</i>	Creating Stored Processes with Dynamic, Cascading Prompts <i>Harry Droogendyk, 27</i>		PROC COMPARE - Worth Another Look! <i>Christianna Williams, 27</i>		Analyst Beware: Five Dangerous Data Step Coding Traps <i>David Abbott, 28</i>		SAS® Macro Dynamics: from Simple Basics to Powerful Invocations <i>Rick Andrews, 28</i>		Beyond the Basics <i>Plaza II</i>	
	Development of a SAS® Macro for Automated Data Cleaning of Major.... <i>Peigang Li, 45</i>		Assign Overpayment to Insurance Data with Adjustments <i>Qiling Shi, 46</i>		My annual reporting is requiring a full staff - Help! <i>Erin Lynch, 46</i>		Using SAS® to Create Custom Healthcare Graphics <i>Barbara Okerson, 46</i>		Government and Healthcare Applications <i>Plaza I</i>	
Keynote You Could Be A SAS® Nerd If... <i>Kirk Paul Lafler</i>	Ready to Become Really Productive Using PROC SQL? <i>Sunil Gupta, 49</i>		Two Guys On Hash <i>Paul Dorfman, 49</i>						Hands On Workshops <i>Beech</i>	
	Graphing a Progression of Time Series Plots <i>Nate Derby, 65</i>		Printable Spreadsheets Made Easy: Utilizing the SAS® Excel XP Tagset <i>Rick Andrews, 66</i>		Quick and Dirty Formatted Excel Workbooks Without DDE or ODS <i>Andrea Wainwright-Zimmerman, 66</i>		SAS® Code to Export and Create Pivot Tables in Excel 2007 <i>Robert Williams, 66</i>		Reporting & Information Visualization <i>Plaza III</i>	
Plaza Ballroom B & C <i>(Pick up your breakfast in the Plaza Ballroom Foyer. Tables and coffee available in the ballroom)</i>	An Exact Implicit Enumeration Algorithm for Variable Selection in Multiple Linear Regression ... <i>Dennis Beal, 74</i>		Acknowledging the Unknown: A SAS® Macro for Investigating... <i>Jason Schoeneberger, 74</i>		Eyes on the Road: A Methodology for Analyzing Complex Eye-Tracking Data <i>Mary Anne Bertola, 75</i>		Linear Logistic Test Model: Using SAS® to Simulate the Decomposition of... <i>George MacDonald, 76</i>		Statistics and Data Analysis <i>Aspen</i>	
	Fuzzy matching - Is there a silver bullet? <i>Milorad Stojanovic, 69</i>		Why the Bell Tolls 108 times? Stepping Through Time with SAS® <i>Peter Eberhardt, 69</i>		A Step by Step Approach to Preparing for a SAS® Intelligence Platform Environment Deployment/Migration <i>Brian Varney, 70</i>		Introduction to SAS® Macro Language <i>John Myers, 70</i>		Step By Step <i>Juniper</i>	
You Want ME to use Enterprise Guide?? <i>Vince DelGobbo, 17</i>				Calling SAS Procedure from the SAS/IML Matrix Language <i>Rick Wicklin, 17</i>				Sas.Community.org Super Demo <i>Howard Schreier, 18</i>		Super Demo Theater SAS® Demo Room - Terrace
Do you have Code / Logic problems? <i>Walk-Ins Welcomed</i>		Code Doctors on Duty: <i>Kirk Paul Lafler</i> <i>Taylor Lewis</i>								Code Doctors SAS® Demo Room - Terrace

Breaks
10:15 – 11:00
3:00 – 3:45

Plaza Ballroom Foyer

Lunch
11:45 – 1:15

Plaza B & C

SAS® Demo Room
9:00-11:00

Terrace

Schedule At a Glance Sponsored By:



Tuesday Afternoon Schedule At A Glance

1 ⁰⁰	1 ³⁰	2 ⁰⁰	2 ³⁰	3 ⁰⁰	3 ³⁰	4 ⁰⁰	4 ³⁰	5 ⁰⁰				
Combining External PDF Files by Integrating SAS® and Adobe® Acrobat <i>Brandon Welch, 28</i>		Condensed and Sparse Indexes for Sorted SAS® Datasets <i>Mark Keintz, 29</i>		Build Excel-Like Pivot Table Using PROC SQL and PROC TRANSPOSE <i>Mai Nguyen, 29</i>		ExcelXP on Steroids: Adding Custom Options to the ExcelXP Tagset <i>Michael Molter, 30</i>		Beyond the Basics <i>Plaza II</i>				
The Last Line <i>Brandon Barrett, 35</i>	RDPLLOT: A SAS® Macro for Generating Reg.... <i>Jason Schoeneberger, 35</i>	Show Me The Folder <i>Brandon Barrett, 36</i>	How variable-dependent macros can help... <i>Mindy Wang, 36</i>	Intelligent Proc Sort Nodupkey <i>Andrea Wainwright-Zimmerman, 36</i>	Using SAS® to Report Data in XML Format <i>Qin Wang, 37</i>	Creating a Stored Macro Facility in 10 Minutes <i>Erik Larsen, 37</i>	Three Easy Ways around Nonexistent or Empty... <i>Spencer Childress, 38</i>	The Little Engine That Could: Using LIBNAME <i>William Benjamin Jr, 38</i>	Proc Format, a Speedy Alternat <i>Claudine Lougee, 38</i>	Can you decipher the code? If you can, maybe ... <i>Jay Iyengar, 39</i>	Use Your Cores! An Introduction to Multicore Processing <i>Erik Dilts, 39</i>	Coders Corner <i>Plaza III</i>
SAS® Enterprise Business Intelligence <i>Harry Droogendyk, Brian Varney, Migdalen Eley, 19</i>		In-House SAS® User Groups <i>Rick Andrews, David Chapman, Manuel Figallo-Monge, David Wilson, 19</i>		Online Communities and Social Media <i>Peter Flom, Joe Kelley, Howard Schreier, Lainie Hoverstad (SAS), 19</i>				Panel Discussions <i>Plaza I</i>				
SAS® Certification Testing (extra fee event)								SAS® Certification <i>Beech</i>				
Conference Workshops (extra fee event) -Analyzing Complex Survey Data in SAS®, <i>Taylor Lewis</i> -An Introduction to Point-and-click Programming Using SAS® Enterprise Guide, <i>Kirk Lafler and Mira Shapiro</i>								Conference Workshops <i>Aspen & Juniper</i>				

Meeting Room Layout Main Tower Lower Level

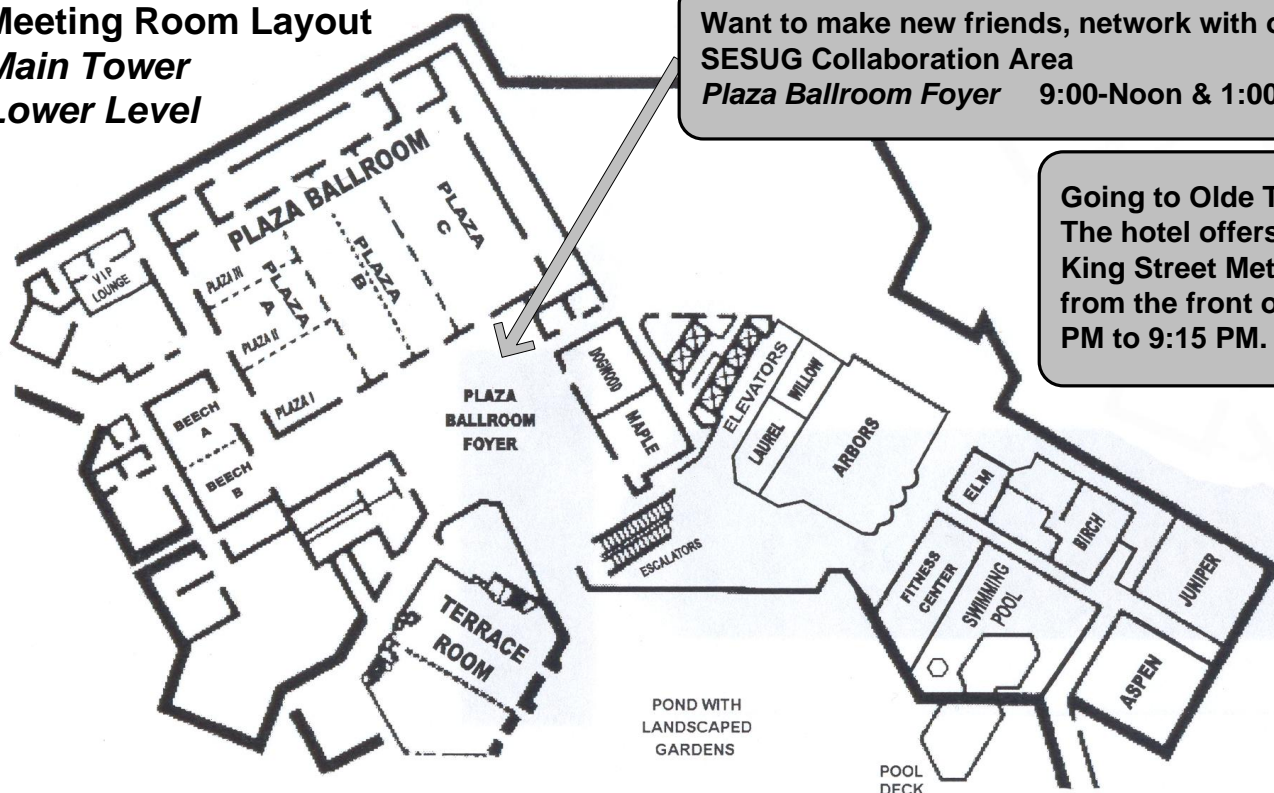

Want to make new friends, network with other attendees or share ideas, come to the **SESUG Collaboration Area**
Plaza Ballroom Foyer 9:00-Noon & 1:00-5:00

Going to Olde Town Alexandria with other attendees for dinner. The hotel offers a complimentary shuttle service to & from the King Street Metro (on the blue and yellow lines). Shuttles depart from the front of the hotel at 15 minutes past the hour from 3:15 PM to 9:15 PM. The shuttle is on a first come, first serve basis.

Legend

Modular Programming <i>MacRoe, 45</i>	Paper Title
Primary Author	Abstract Page in Program
SAS Institute Presenter	Presenter or Co-author is a Student Scholarship Winner